

RF23982

BLACK LED DIMMER

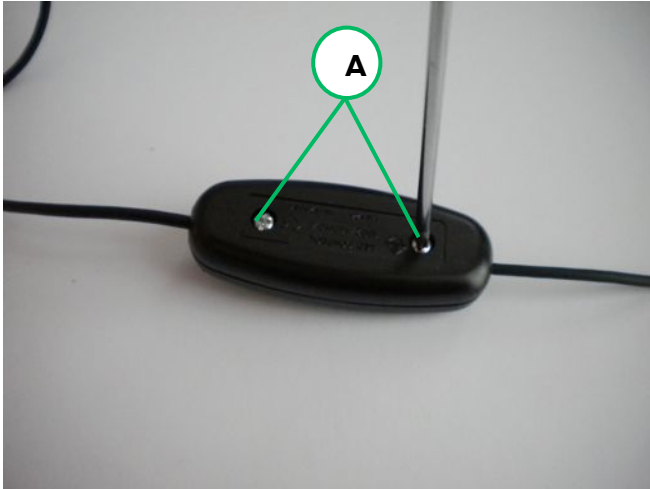

WARNING! When installing and whenever acting on the appliance, ensure that the power supply has been switched off.
For the installation of the spare-part, it is necessary to consult a qualified electrician.



Unfasten the 2 screws (A) from underneath the dimmer and remove the dimmer cover (B).

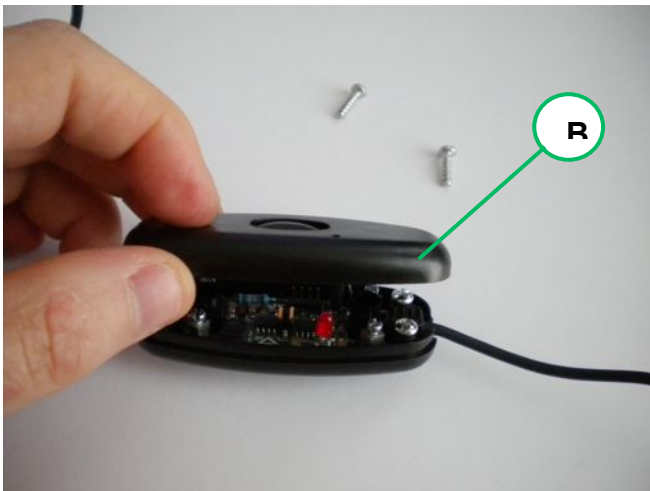

FLOS U.S.A., Inc. 110 York Street, 5th Floor, Brooklyn, NY 11201 | Tel: 718-875-3472 | Email: e-shop@flosusa.com | <http://usa.flos.com>

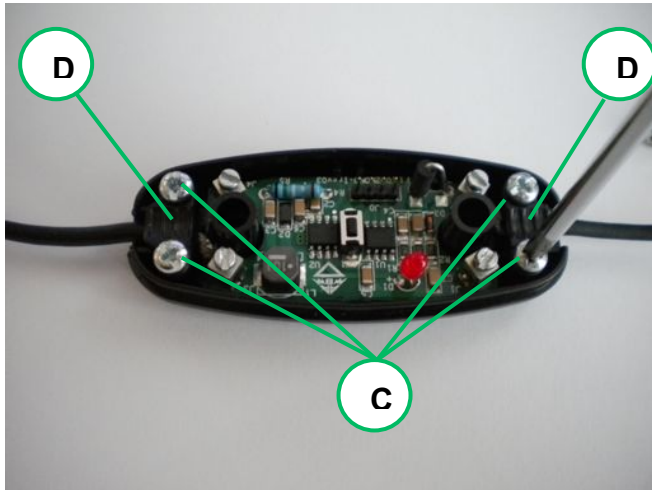

Unfasten the 4 screws (C) of the cable clamp (D) and disconnect the wires from the terminal box (F) through a tiny flat headed screw driver.

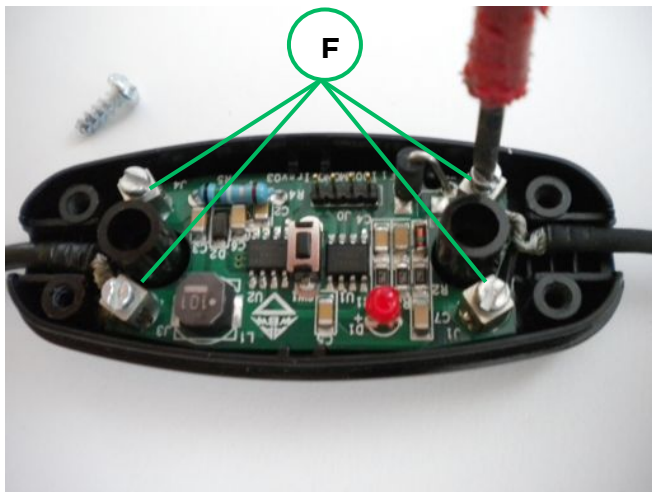

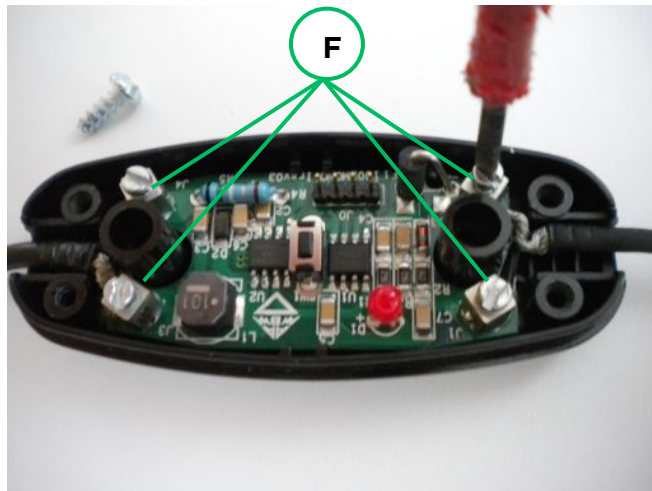

Assemble now the new spare-part:

Connect the electrical wires to the terminal (F) of the dimmer.

Position the cable clamp (D) and fasten back the screws (C).

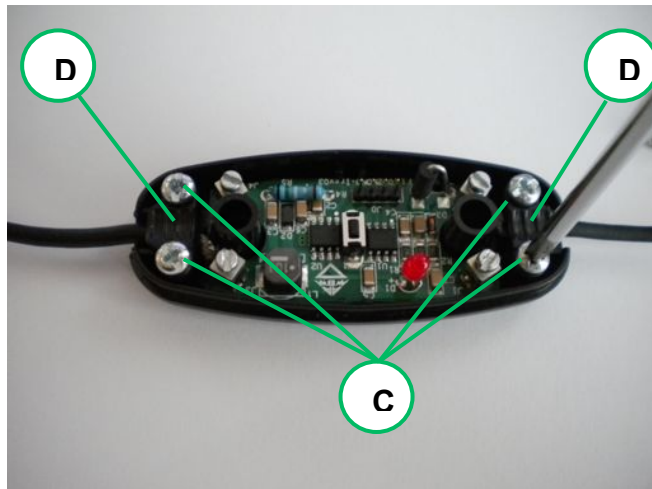

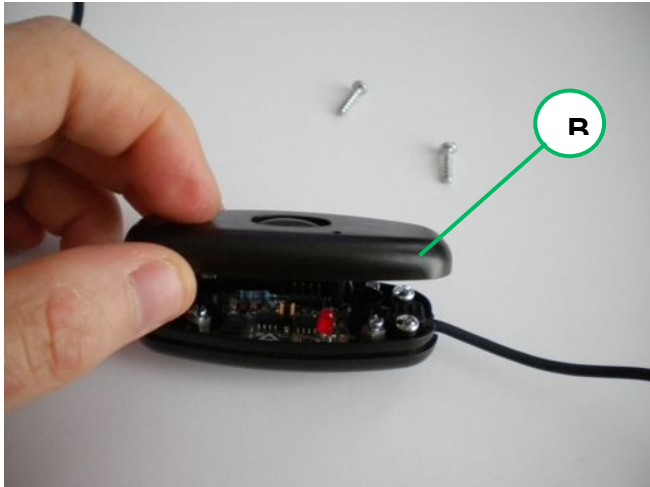

Close the dimmer by positioning the cover (B) and fastening the 2 screws (A)

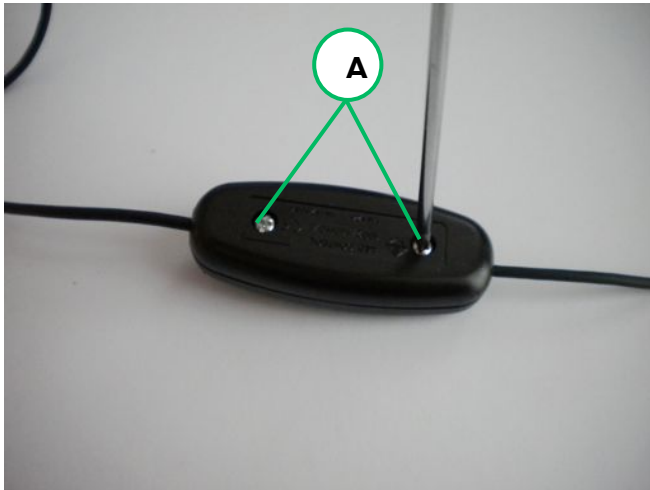

TECHNICAL DATA SHEET

Corrente nominale <i>Rated current</i>	mA	700	
Tensione nominale <i>Rated voltage</i>	Vac/dc Vdc	12	24
Potenza massima <i>Max power</i>	W	8,4	16,8
Temperatura di lavoro <i>Working temperature</i>	°C	0-40	
Sezione cavi di ingresso <i>Input cable section</i>	mm ²	1,5	
Dimensioni <i>Dimensions</i>	mm	70x28,8x16,5	
Peso unitario <i>Weight</i>	g	35	

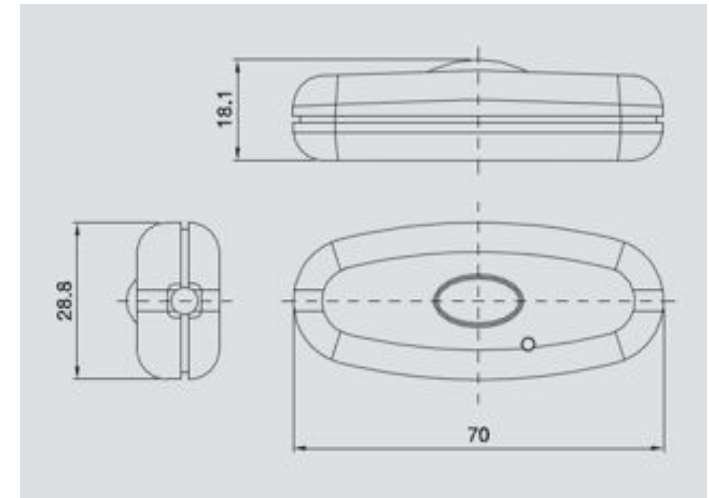

Attention!!! Dimensions in the present drawing are in mm.

PWM mode electronic dimmer for LED modules in constant current mode.

Power ON and integrated night-light LED. System functions: softstart, brightness level memory, minimum and maximum stop options.

No automatic-on function when commanded through the

ELECTRICAL CONNECTION

