

POWER SUPPLY KIT ARRANGEMENTS SMALL/NOCTAMBULE



RF0410500

INDEX

- **ARRANGEMENTS SMALL Page 3**
- **NOCTAMBULE SPage 10**

FLOS

ARRANGEMENTS SMALL INSTRUCTIONS

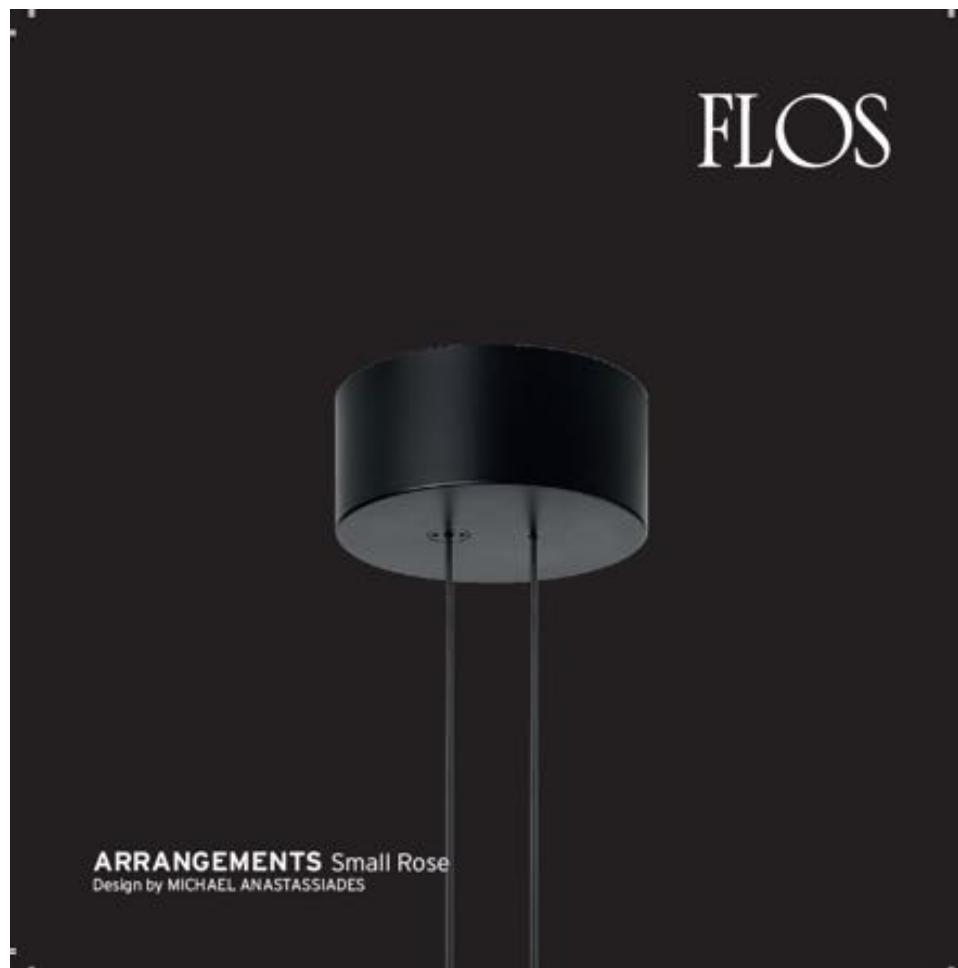

FLOS U.S.A., Inc. 110 York Street, 5th Floor, Brooklyn, NY 11201 | Tel: 718-875-3472 | Email: e-shop@flosusa.com | <http://usa.flos.com>

This document is exclusive property of Flos S.p.A. and its affiliated companies.



WARNING! When installing and whenever acting on the appliance, ensure that the power supply has been switched off. For the installation of the spare-part, it is necessary to consult a qualified electrician.

Remove the cover.





Unscrew the N°3 screws from the black support using an allen key.

Remove the black support from the ceiling attach.



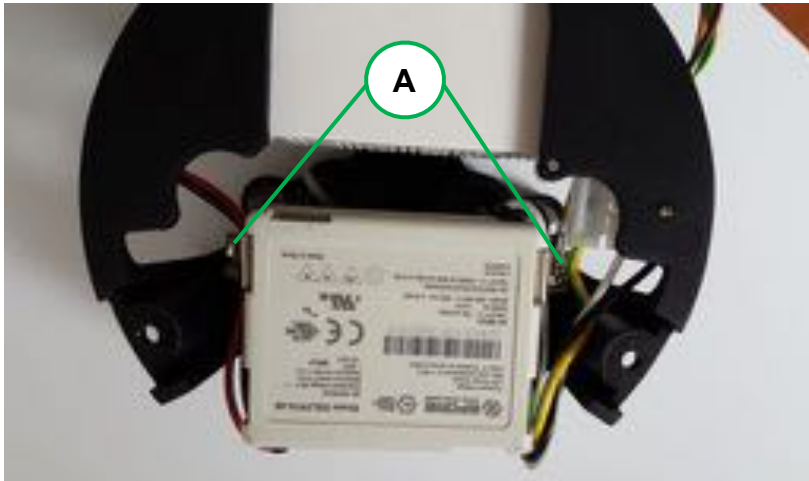

Unscrew the screws (A & B) from the old Power Supply using a screwdriver.

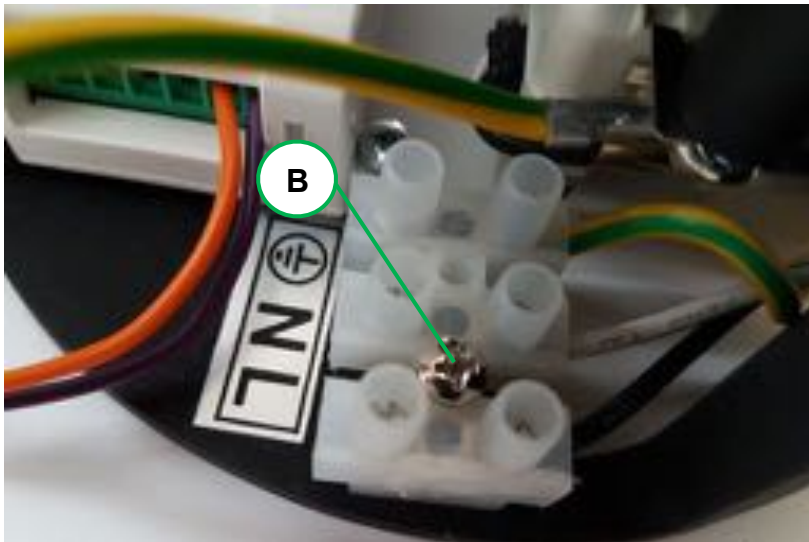

Remove the old Power Supply.

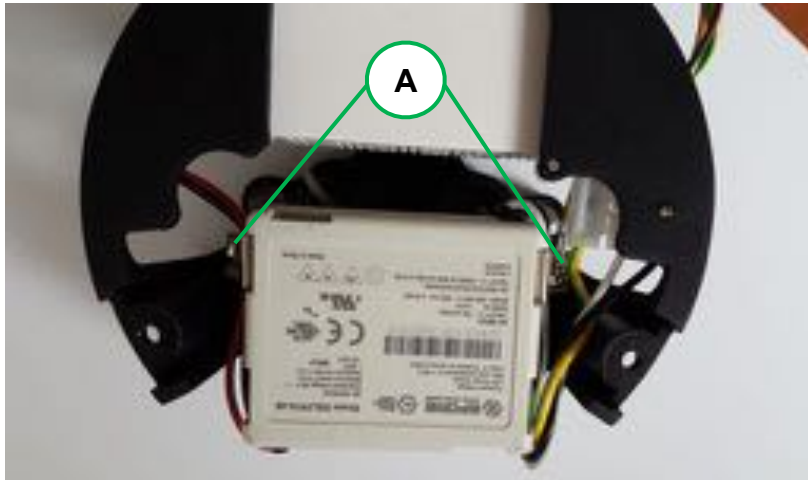

Position the new Power Supply in the ceiling rose.

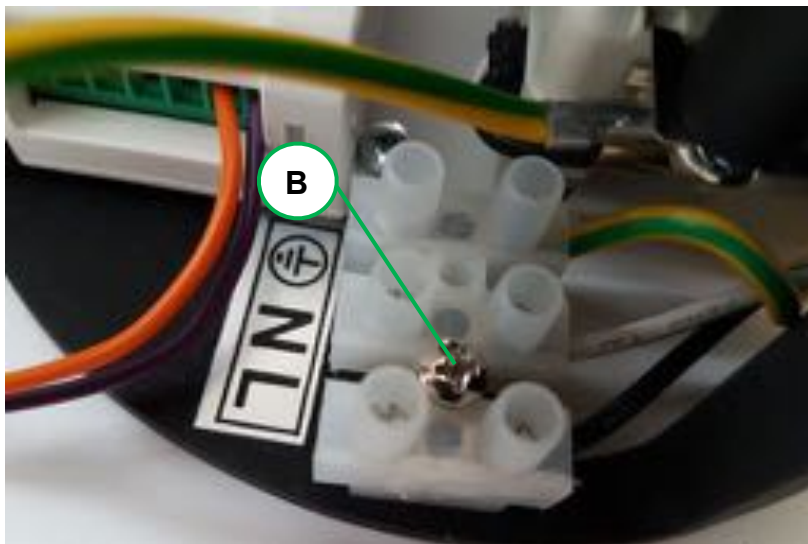

Fasten back the screws (A & B) of the new Power Supply using a screwdriver.



Position the black support on the ceiling attached and fasten back the N°3 screws using an allen key.





Place the cover on the ceiling rose.

FLOS

NOCTAMBULE S INSTRUCTIONS



FLOS U.S.A., Inc. 110 York Street, 5th Floor, Brooklyn, NY 11201 | Tel: 718-875-3472 | Email: e-shop@flosusa.com | <http://usa.flos.com>

This document is exclusive property of Flos S.p.A. and its affiliated companies.

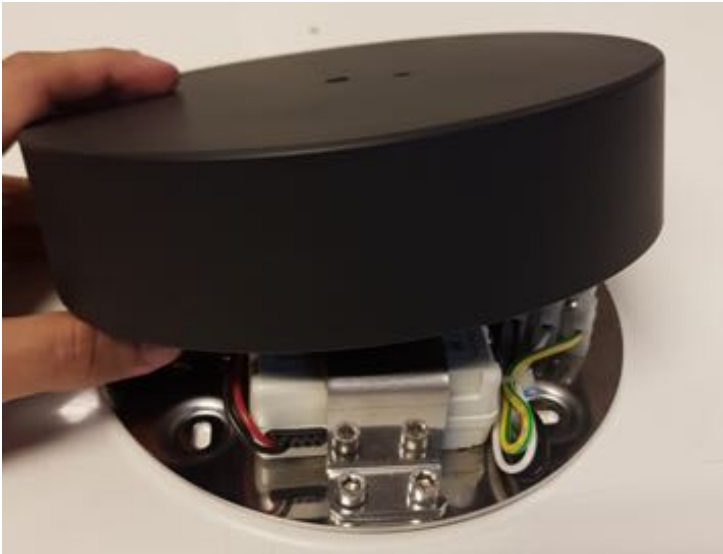

WARNING! When installing and whenever acting on the appliance, ensure that the power supply has been switched off.

For the installation of the spare-part, it is necessary to consult a qualified electrician.

Remove the cover.

Disconnect the Vin and Vout terminals from the dimmer

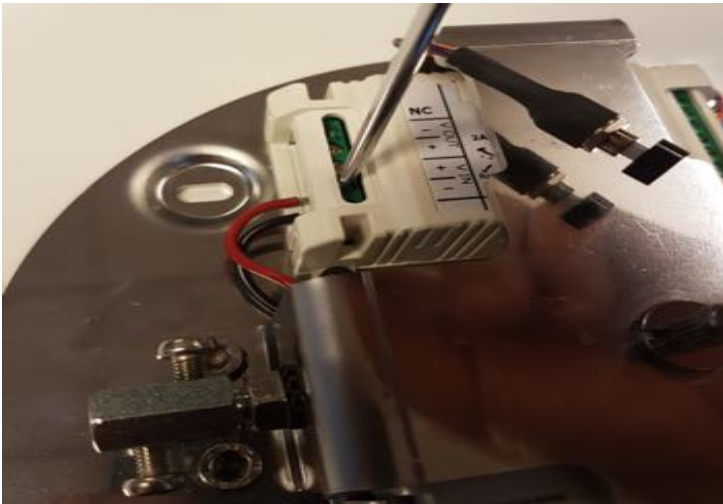

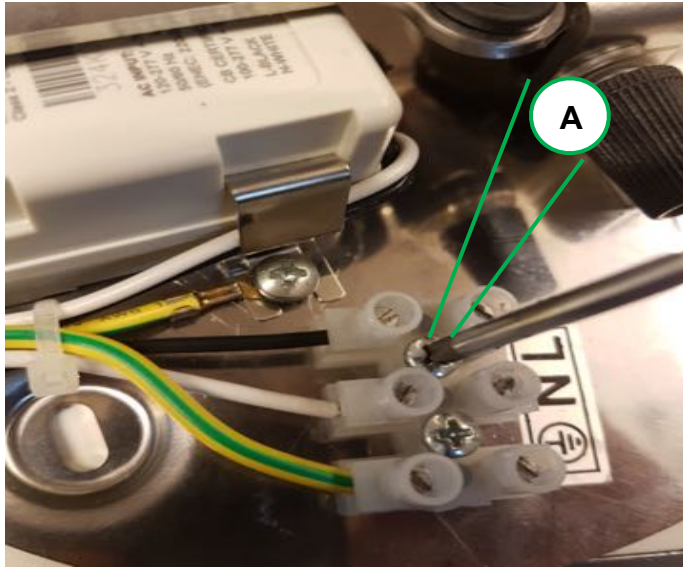

Unscrew the screws (A & B) from the old Power Supply using a screwdriver.

Remove the old Power Supply.



Replace the old Power Supply with the new one.

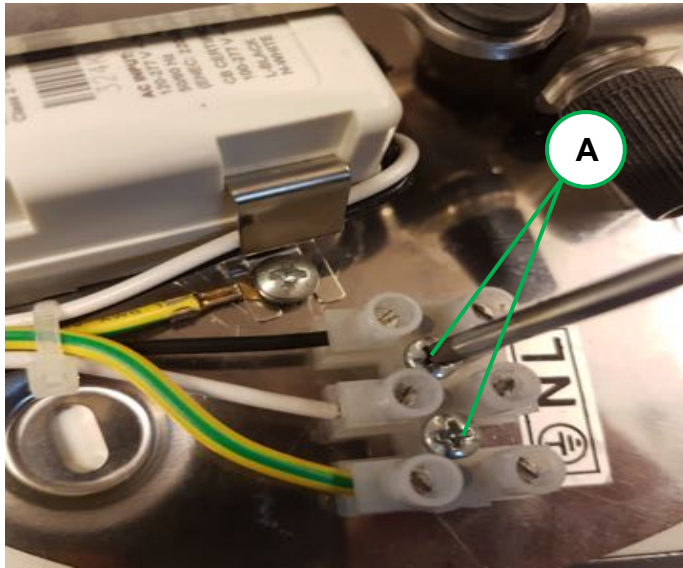

Fasten back the screws (A & B) of the new Power Supply using a screwdriver.

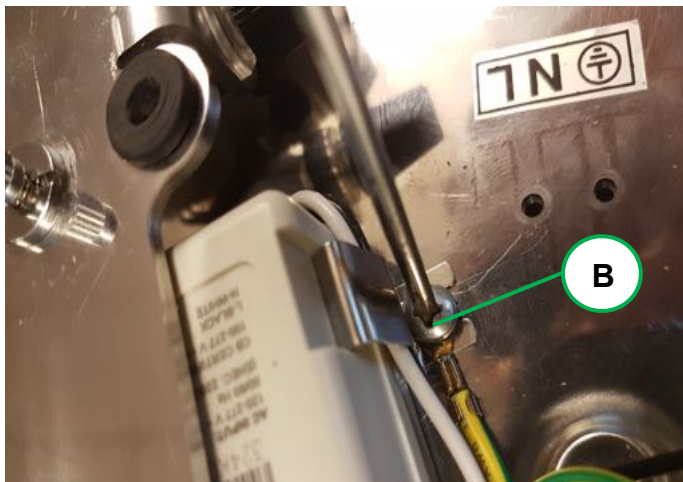

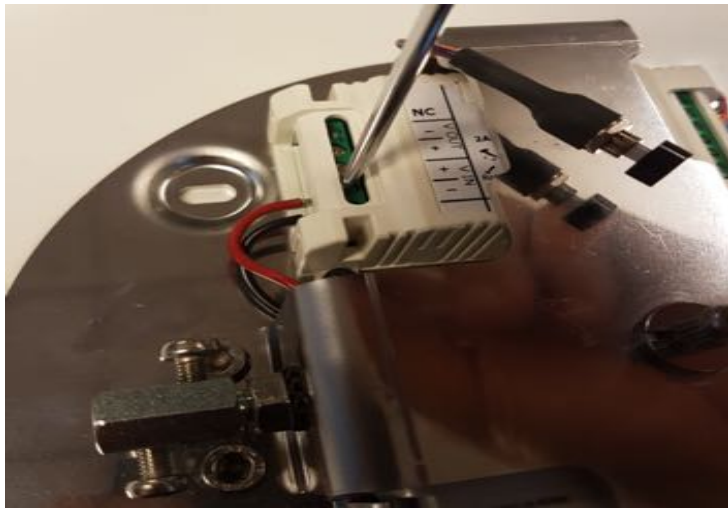

Connect the Vin and Vout terminals to the dimmer using a screwdriver.

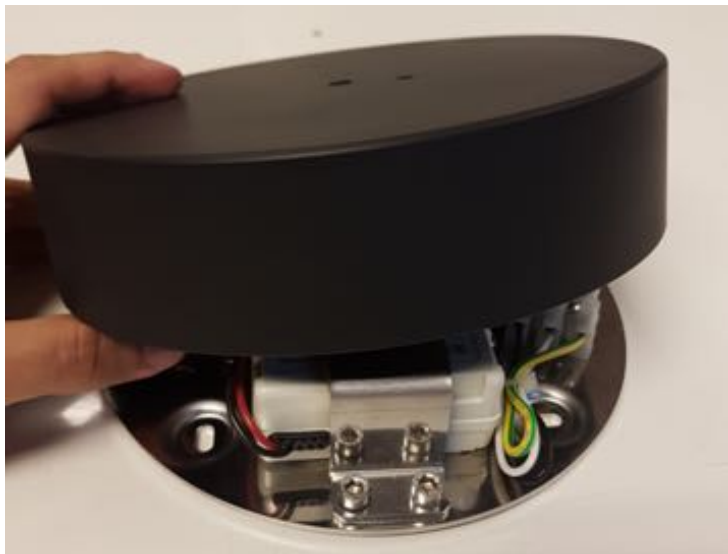

Place the cover on the ceiling rose.

FLOS

FLOS U.S.A., Inc. 110 York Street, 5th Floor, Brooklyn, NY 11201 | Tel: 718-875-3472 | Email: e-shop@flosusa.com | <http://usa.flos.com>

This document is exclusive property of Flos S.p.A. and its affiliated companies.